

Adventure Awaits



2023 RVR



MITSUBISHI
MOTORS

Drive your Ambition



CONFIDENT STYLE WITH A GO ANYWHERE ATTITUDE

Experience a front-row seat to excitement in the rugged, yet highly sophisticated Mitsubishi RVR.

A confident, go-anywhere attitude is powerfully expressed in the RVR's Dynamic Shield styling and cutting-edge LED lighting designs at the front and rear. Along the side, it boasts the sporty look of available 18" alloy wheels to complement the capability of available All-Wheel Control (AWC) - the rally-bred Mitsubishi Motors drivetrain technology that delivers assured footing on all surfaces, in all types of weather.

Under the hood, RVR offers you a choice of well-rounded 2.0 L or 2.4 L 4 cylinder engines, each with a fuel-efficient Continuously Variable Transmission (CVT) for responsive power and effortless cruising.

Let your quest begin in the 2023 Mitsubishi RVR.

THE COMMANDING PERFORMANCE OF AWC

RVR is available with Mitsubishi Motors' legendary All-Wheel Control (AWC) which gives you the ability to choose how engaged the system is. There are three settings available at the touch of a button, optimizing your focus between fuel economy and all-wheel drive capability. **2WD** keeps the vehicle in front-wheel drive regardless of driving conditions, for economical driving on normal dry roads and highways. **4WD AUTO** offers well-balanced 4-wheel drive performance, resulting in enhanced fuel efficiency, traction, high-speed stability and predictable handling based on road and driving conditions.

4WD LOCK increases torque applied to the rear wheels, helping to enhance vehicle performance on slippery surfaces such as snow-covered roads or sand.



FUEL ECONOMY

RVR ES FWD / SE FWD	CITY	HIGHWAY	COMBINED
2.0 L DOHC MIVEC 4 Cylinder Engine	9.7 L/100KM	7.8 L/100KM	8.9 L/100KM
RVR ES AWC			
2.0 L DOHC MIVEC 4 Cylinder Engine	10.0 L/100KM	8.1 L/100KM	9.1 L/100KM
RVR SE AWC / SEL AWC / LE AWC / GT AWC			
2.4 L DOHC MIVEC 4 Cylinder Engine	10.3 L/100KM	8.3 L/100KM	9.4 L/100KM

Continuously Variable Transmission (CVT)
Based on Natural Resources Canada's testing methodology.

DESIGNED FOR YOUR NEXT ADVENTURE



AUTO LED HEADLAMPS & FOG LAMPS



PANORAMIC FIXED GLASS SUNROOF WITH SUNSHADE & LED LIGHTING

LOVE THE COMFORT & ROOMINESS



You'll love the Mitsubishi RVR's generous comforts, modern amenities and surprisingly roomy interior.

Enjoy the genuine warmth of standard heated front seats, and the increased visibility of the 8" Smartphone Link Display Audio System featuring Android Auto™¹ and Apple CarPlay². Or step up to the premium RVR GT AWC with its leather-appointed seats, heated steering wheel and superb 710-watt Rockford Fosgate® Punch® Display Audio System equipped with 9 speakers, including a bass-enhancing 10" subwoofer.

The RVR's spaciousness isn't limited to passengers: it's just as impressive when it comes to accommodating your luggage and gear, thanks to a wide, easy-opening liftgate and convenient, split-folding rear seats.



ALL THE ESSENTIALS FOR GREAT JOURNEYS



UP TO 1,402 L (49.5 CU. FT.) OF CARGO ROOM



8" SMARTPHONE LINK DISPLAY
AUDIO SYSTEM FEATURING
ANDROID AUTO™ AND APPLE CARPLAY



710-WATT ROCKFORD FOSGATE® PUNCH® AUDIO
SYSTEM WITH 9 SPEAKERS INCLUDING SUBWOOFER



HEATED LEATHER-APPOINTED SEATS



HEATED STEERING WHEEL



BECAUSE SAFETY IS EVERYTHING

Nothing matters more than safety - to you and Mitsubishi Motors engineers.

That's why they developed the RVR using Reinforced Impact Safety Evolution (RISE) engineering, utilizing high tensile strength steel and crumple zones that absorb and disperse energy during high-impact collisions. Strategic reinforcements at key body points complement its side-impact door beams, giving your RVR a stable, secure base that's worth its weight in safety.

You'll also appreciate the RVR's advanced airbag systems, as well as driver assistance technologies that help keep you safe.

WARRANTY PROTECTION

AT MITSUBISHI MOTORS, WE'RE SO CONFIDENT IN THE QUALITY, RELIABILITY AND DURABILITY OF THE VEHICLES WE BUILD, THAT WE BACK THEM WITH SOME OF THE MOST COMPREHENSIVE WARRANTIES AVAILABLE.

**10-YEAR/160,000 KM
POWERTRAIN LIMITED WARRANTY***

**5-YEAR/100,000 KM
NEW VEHICLE LIMITED WARRANTY***

**5-YEAR/UNLIMITED KM
ROADSIDE ASSISTANCE***

MORE PEACE OF MIND

THESE SAFETY FEATURES ARE STANDARD ON ALL RVR TRIM LEVELS:

ANTI-LOCK BRAKING SYSTEM (ABS)

ELECTRONIC BRAKE-FORCE DISTRIBUTION (EBD)

ACTIVE STABILITY CONTROL (ASC)

BRAKE ASSIST SYSTEM (BAS)

TRACTION CONTROL LOGIC (TCL)

TIRE PRESSURE MONITORING SYSTEM (TPMS)

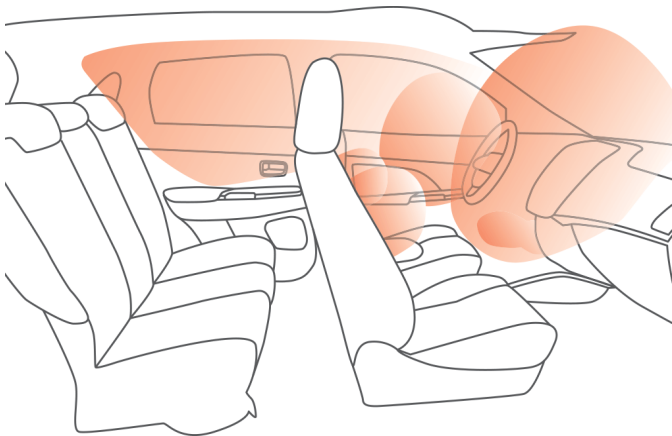

7 Standard Airbags

Help protect you and your passengers in a variety of collision situations. Protection includes dual front airbags, front seat-mounted side-impact airbags, side-impact curtain airbags (front and rear) and a driver's knee airbag.

Danger of collision: warning + braking assistance

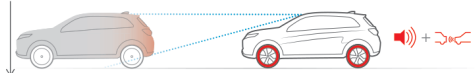

High danger of collision: warning + auto-braking

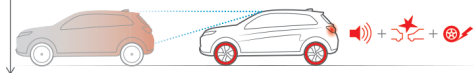

Extremely high danger of collision: warning + strong auto-braking

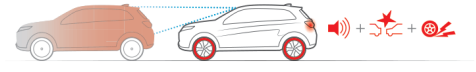

Responds to vehicles and pedestrians.

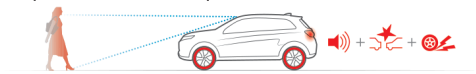

Forward Collision Mitigation (FCM)¹

Utilizes both laser radar and camera technology to determine if a frontal collision is imminent. If so, it warns you with audible and visual signals, and automatically applies moderate to emergency braking to reduce the severity of the collision and, if possible, prevent the collision altogether.

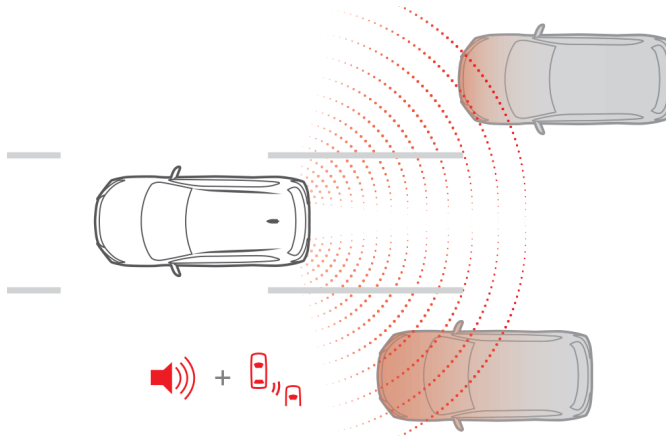

Blind Spot Warning (BSW)¹

Alerts you when a vehicle is in or approaching your blind spot. When a vehicle in the next lane is travelling at the same speed or faster in the detection areas, a warning light illuminates on the corresponding side mirror. If you switch the turn signal on, the warning light on the corresponding mirror will blink and the system will beep three times to alert you that it is unsafe to change lanes.

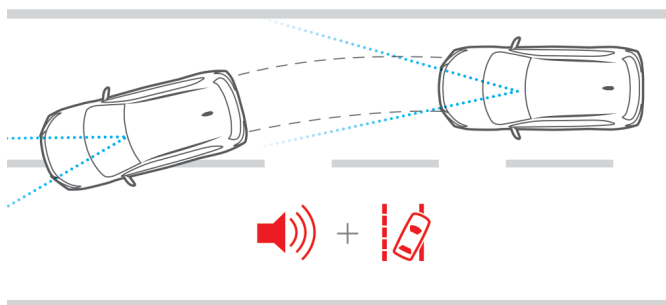

Lane Departure Warning (LDW)¹

Uses an onboard camera to monitor lane position in front of the vehicle, providing audible and visual alerts if it detects your vehicle leaving the lane unintentionally.

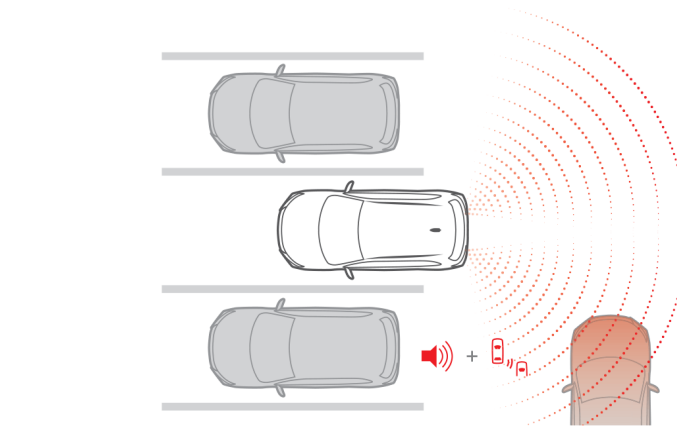

Rear Cross Traffic Alert (RCTA)¹

Detects a vehicle approaching from the side while you're backing up. It alerts you with flashing warning lights on both side mirrors, a buzzer that sounds in the cabin and a warning message that appears in the instrument cluster.

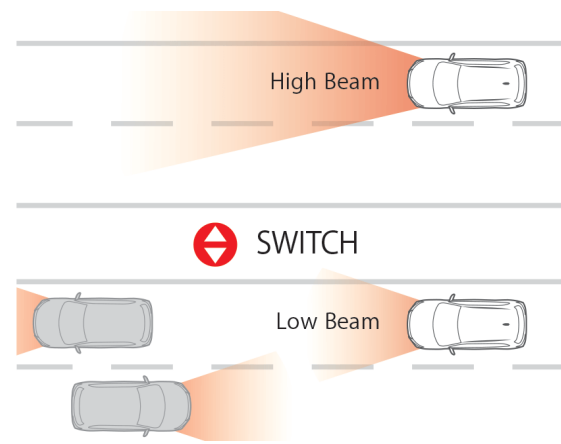

Auto LED High Beams (AHB)¹

Detects light levels of oncoming vehicles and automatically switches the RVR's headlamps between low and high beams – a welcome safety feature when driving on dimly-lit roads.

¹ Advanced safety systems are driver aids only and are not a substitute for safe and careful driving. Under certain conditions, the systems have detection, capacity and other operational limits. Drivers are fully responsible for their own safe driving. Please drive safely and do not rely solely on these systems. See Owner's Manual or mitsubishi-motors.ca/en/advancedsafety for full details, conditions and limitations.

ES FWD / STANDARD SPECIFICATIONS:

- 2.0 L DOHC MIVEC 4-CYLINDER ENGINE
- CONTINUOUSLY VARIABLE TRANSMISSION (CVT)
- HEATED FRONT SEATS
- 8" SMARTPHONE LINK DISPLAY AUDIO FEATURING ANDROID AUTO™ AND APPLE CARPLAY
- SIRIUSXM® SATELLITE RADIO WITH 3-MONTHS COMPLIMENTARY SERVICE
- HEATED POWER SIDE VIEW MIRRORS
- AUTO LED HEADLAMPS AND LED DAYTIME RUNNING LAMPS
- RAIN-SENSING WINDSHIELD WIPERS

SE FWD / INCLUDES ALL THE EQUIPMENT OF THE ES FWD PLUS:

- 16" ALLOY WHEELS
- 6 SPEAKERS
- LED FRONT FOG LAMPS
- BLIND SPOT WARNING (BSW)
- LEATHER-WRAPPED STEERING WHEEL & GEAR SHIFT KNOB
- REAR CROSS TRAFFIC ALERT (RCTA)
- REAR PRIVACY GLASS

ES AWC / INCLUDES ALL THE EQUIPMENT OF THE ES FWD PLUS:

- ALL WHEEL CONTROL (AWC) WITH DRIVE MODE SELECTOR (2WD/4WD AUTO/4WD LOCK)

SE AWC / INCLUDES ALL THE EQUIPMENT OF THE SE FWD PLUS:

- 2.4 L DOHC MIVEC 4-CYLINDER ENGINE
- PREMIUM FABRIC-APPOINTED SEATS
- ALL WHEEL CONTROL (AWC) WITH DRIVE MODE SELECTOR (2WD/4WD AUTO/4WD LOCK)

MOST POPULAR

SEL AWC / INCLUDES ALL THE EQUIPMENT OF THE SE AWC PLUS:

- FAST KEY KEYLESS ENTRY WITH PUSH BUTTON START AND PANIC ALARM
- 18" ALLOY WHEELS
- FAUX SUEDE APPOINTED SEATS
- BLACK ROOF RAILS
- HEATED STEERING WHEEL



LE AWC / INCLUDES ALL THE EQUIPMENT OF THE SEL AWC PLUS:

- BLACK GRILLE AND EXTERIOR ACCENTS
- 18" BLACK PAINTED ALLOY WHEELS
- LEATHER-WRAPPED STEERING WHEEL & GEAR SHIFT KNOB WITH RED STITCHING
- BLACK HEADLINER
- ALUMINUM PEDALS
- PADDLE SHIFTERS
- REMOTE ENGINE STARTER



GT AWC / INCLUDES ALL THE EQUIPMENT OF THE SEL AWC PLUS:

- PANORAMIC FIXED GLASS SUNROOF WITH SUNSHADE AND LED LIGHTING
- 710 WATT ROCKFORD FOSGATE® PUNCH® AUDIO SYSTEM WITH 9 SPEAKERS INCLUDING 10" SUBWOOFER
- PADDLE SHIFTERS
- HEATED & POWER-FOLDING SIDE VIEW MIRRORS
- AUTO-DIMMING REARVIEW MIRROR WITH HOMELINK
- REMOTE ENGINE STARTER
- AUTO LED HIGH BEAMS (AHB)
- FORWARD COLLISION MITIGATION (FCM)
- LANE DEPARTURE WARNING (LDW)
- LEATHER APPOINTED SEATS WITH CONTRAST STITCHING
- 6-WAY POWER DRIVER'S SEAT
- BLACK HEADLINER

FOR A COMPLETE LIST OF FEATURES, TECHNICAL SPECIFICATIONS AND OPTIONS, VISIT MITSUBISHI-MOTORS.CA



OAK BROWN

OCTANE BLUE

SUNSHINE ORANGE

RED DIAMOND

TITANIUM GREY

STERLING SILVER

WHITE DIAMOND

LABRADOR BLACK

PERSONALIZE YOUR RVR

You chose the Mitsubishi RVR because it best fits you and your lifestyle – now it's time to make it uniquely yours. Mitsubishi Motors Genuine Accessories are designed specifically for your RVR, to offer added convenience, protection and style, as you see fit. A perfect fit to be precise, meeting all required standards and covered under a Mitsubishi Motors warranty.

Personalize, customize and accessorize your RVR your way... just be prepared to get noticed.

- REMOTE STARTER
- WHEEL LOCKS
- ALL-WEATHER FLOOR GUARDS
- CARGO LINER
- BLOCK HEATER
- MUDGUARDS (FRONT & REAR)
- HOOD PROTECTOR
- REAR BUMPER PROTECTION PLATE
- SIDE WINDOW DEFLECTORS

Technical data, equipment, options shown and other content are based on the latest information available at the time of printing and are subject to change without notice. Colours may vary due to the printing process. Exterior and interior lights on vehicles shown may be illuminated for illustration purposes only. Vehicles are shown with optional equipment and/or accessories or images may be international models shown. Not all equipment is available on every model. For complete details about equipment configuration and Mitsubishi Motors Genuine Accessories, please contact your Mitsubishi Motors Retailer. ¹2022 Mitsubishi Motor Sales of Canada Inc. ²Advanced safety systems are driver aids only and are not a substitute for safe and careful driving. Under certain conditions, the systems have detection, capacity and other operational limits. Drivers are fully responsible for their own safe driving. Please drive safely and do not rely solely on these systems. See Owner's Manual or mitsubishi-motors.ca/en/advancedsafety for full details, conditions and limitations. ¹To use Android Auto on your phone screen, you'll need an Android phone running 5.0 (Lollipop) or higher and the Android Auto app. Google, Google Play, Android, Android Auto, and other marks are trademarks of Google LLC. ²Apple CarPlay and Siri are trademarks of Apple Inc., registered in the U.S. and other countries. The Bluetooth word mark and logos are owned by Bluetooth SIG, Inc., and any use of such marks by Mitsubishi Motors is under license. ³2022 SiriusXM Canada Inc. "SiriusXM", SiriusXM Satellite Radio subscriptions sold after 3 month prepaid period expires. Subscriptions are governed by SiriusXM Customer Agreement; see siriusxm.ca. "SiriusXM", the SiriusXM logo, channel names and logos are trademarks of SiriusXM Radio Inc. and are used under license. ⁴Whichever comes first. Regular maintenance not included. See dealer or mitsubishi-motors.ca for warranty terms, restrictions and details. Not all customers will qualify.